

Welcome To George
Washington's
Model "A"
Episode 1

Front End Basics On Your Model A



The Pieces and The Parts

- Front Radius Rod to Front Axle Assembly
- Front Radius Rod to Ball Joint Assembly
- Front Spring to Front Axle Assembly
- Spindle Assembly



The Pieces and The Parts

- Front Radius Rod to Front Axle Assembly
- Front Radius Rod to Ball Joint Assembly
- Front Spring to Front Axle Assembly
- Spindle Assembly



The Model A Front End and Suspension

The suspension assembly's main function is to allow the front end to move and articulate the ground. Together with the rear end the Model A's suspension acts like two triangles pivoting from a central point on the car.

- The front end pivots at the radius rod ball joint-mounted on the clutch Housing-and the front cross member at the spring by way of the spring perches.
- Due to this configuration the Model A does not provide a ride like a modern car.



The Front Radius Rod to Front Axle Assembly

Bushing are as easy as 1-2-3. Just watch this quick video on using the Bushing Driver Tool.



Some Perches can be very difficult to get out.

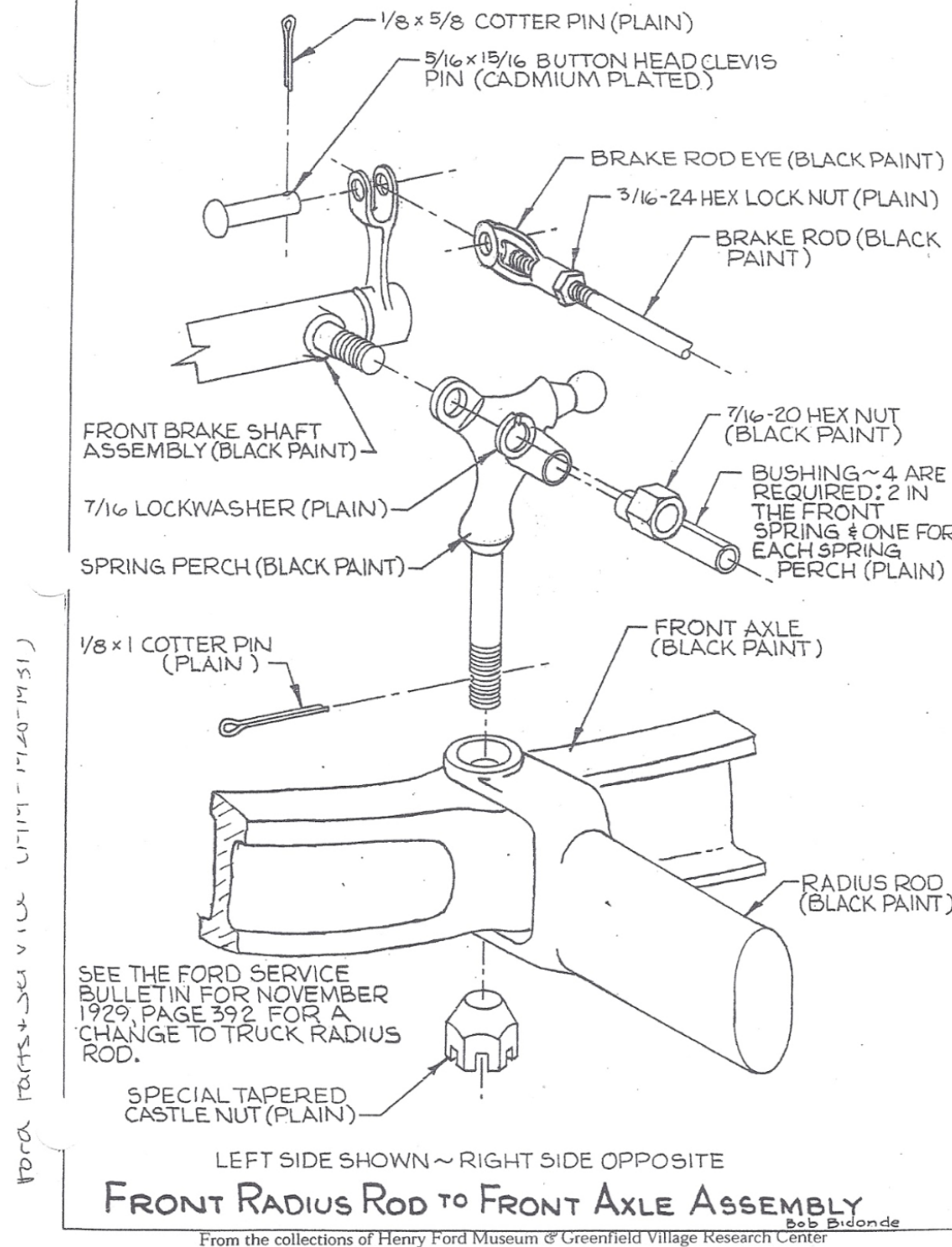

The Radius Rod Ball Joint Assembly

This Assembly is one of two points where the whole front end pivots.

Below is an example of old school ball repair for a worn radius rod ball. What you should have is pictured left. Another option for a worn ball is a "Front Radius Ball Spacer", (Brattons PT No. 4691)

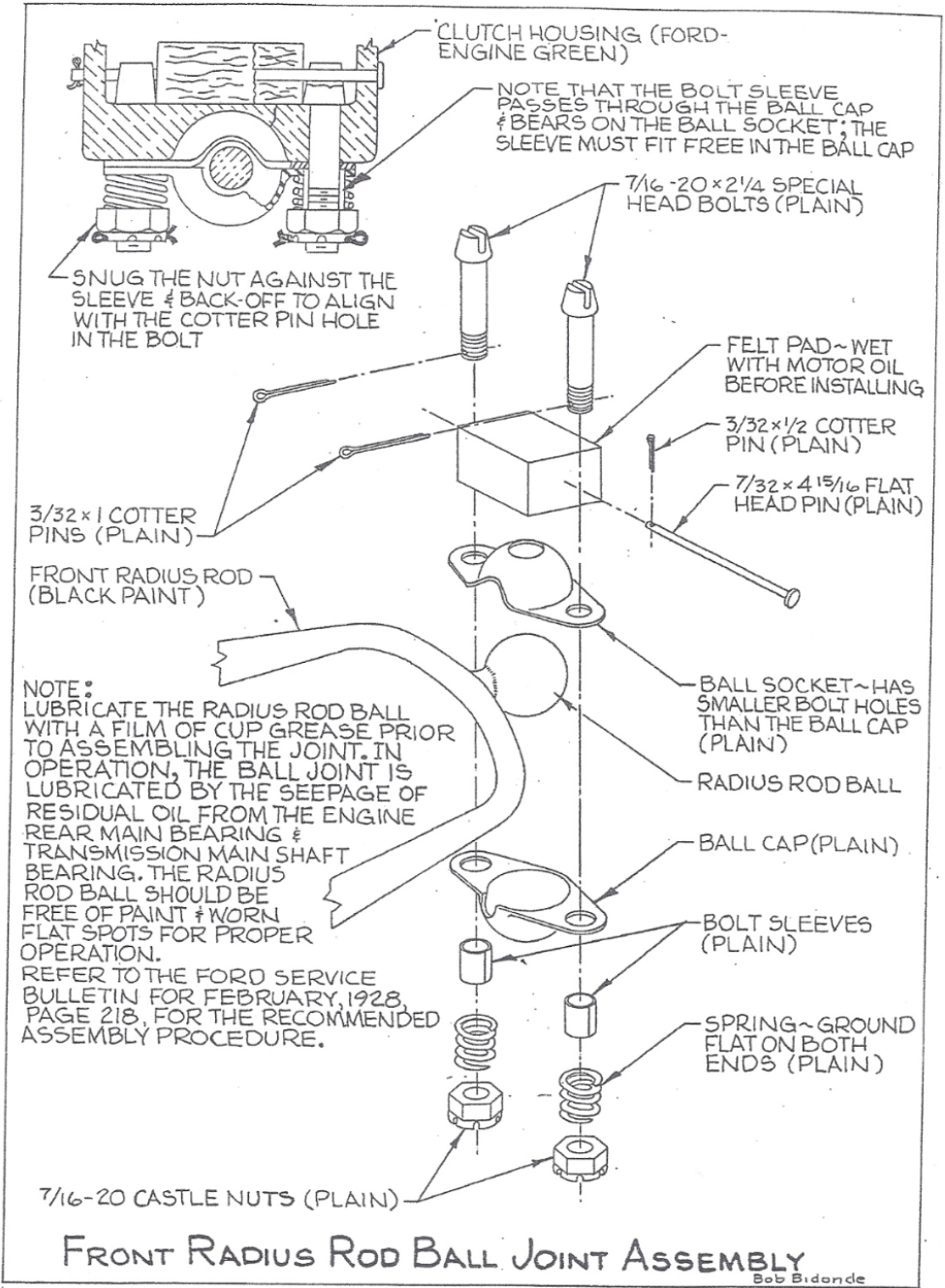

The Front Spring to Front Axle Assembly

The spring connects to the front axle by way of the two spring perches. This spring connects to the front cross member. There are two ways this spring is connected, the 28-30 uses a “Front Spring Clip U-bolt” and Feb 30-31 they used a “Front Spring U-bolt”. (Per Brattons Catalogue.)

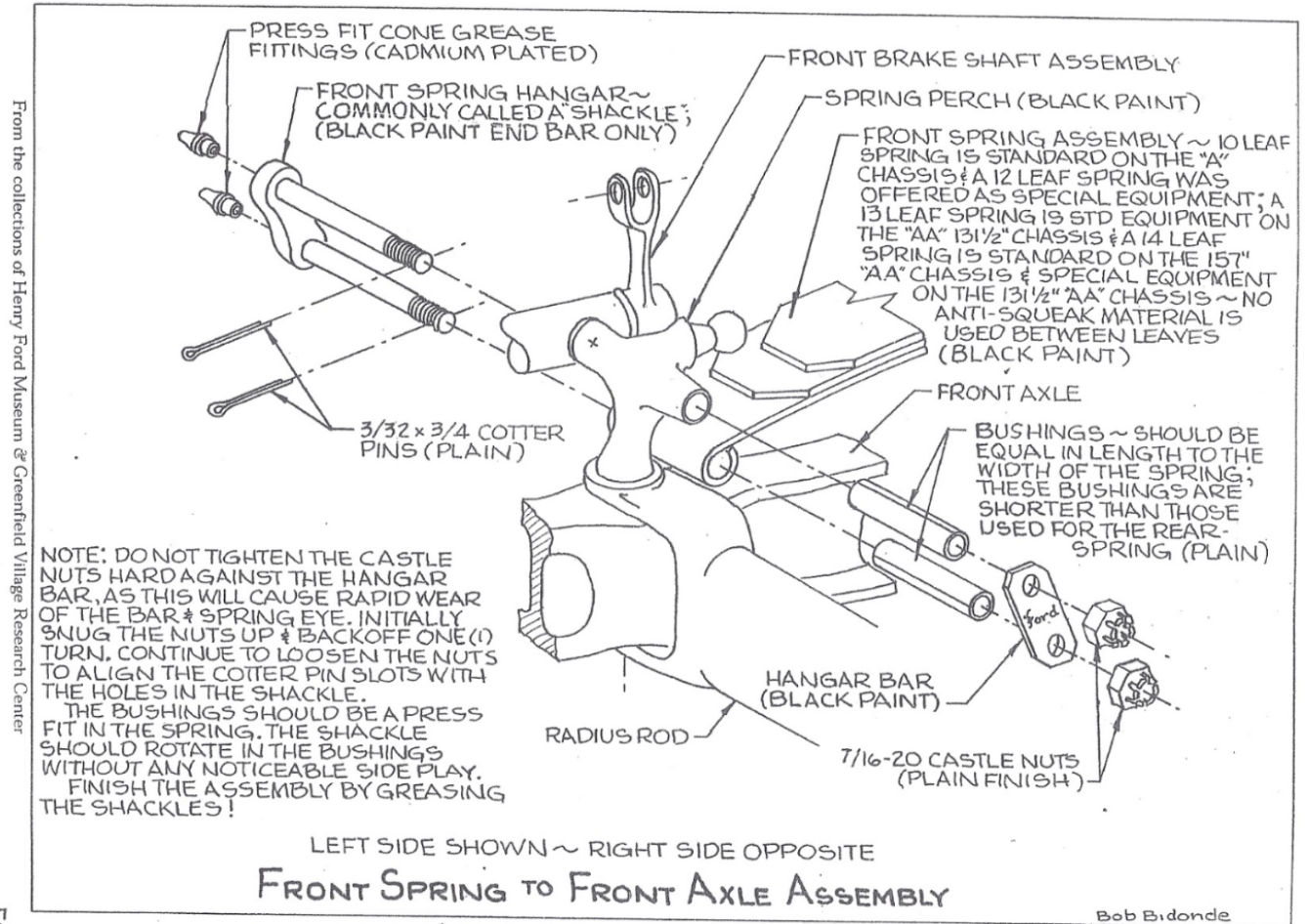

The Front Spring to Front Axle Assembly

The spring connects to the front axle by way of the two spring perches. This spring connects to the front cross member. There are two ways this spring is connected, the 28-30 uses a “Front Spring Clip U-bolt” and Feb 30-31 they used a “Front Spring U-bolt”. (Per Brattons Catalog.)

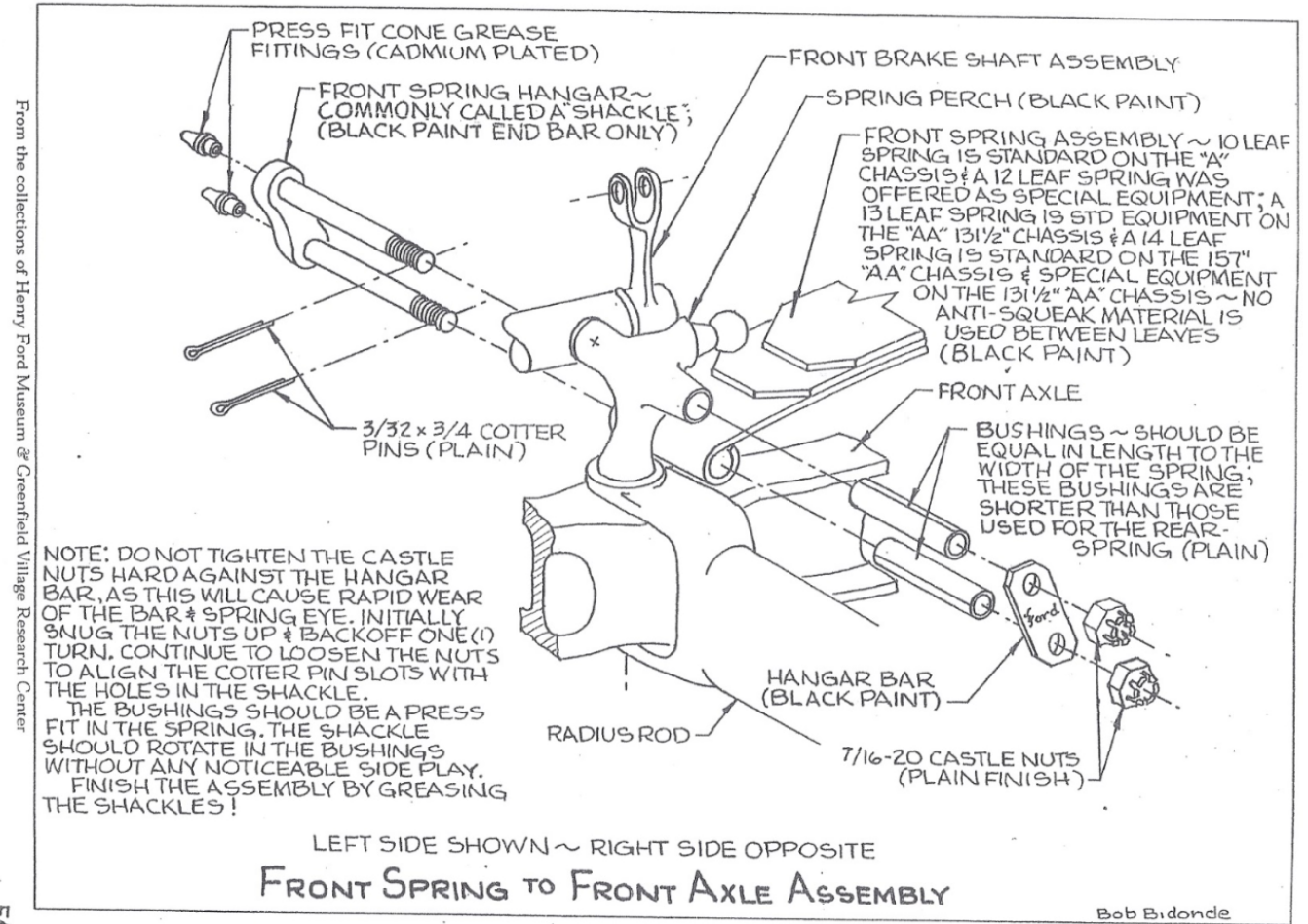

Spindle and King Pin Assembly

King Pins or bushings can cause looseness or drifting of the car while driving. Other components can cause this problem as well but will not be addressed at this tie.

“The new thrust bearings are thinner than the original bearings. One or two shims will be needed to take up the difference. This will allow the thrust bearings to support the total weight of the car, producing easy and smooth steering..... To check for proper installation try to rotate the thrust bearing on top of the axle, it should not rotate.” If it does rotate add a shim under the thrust bearing.

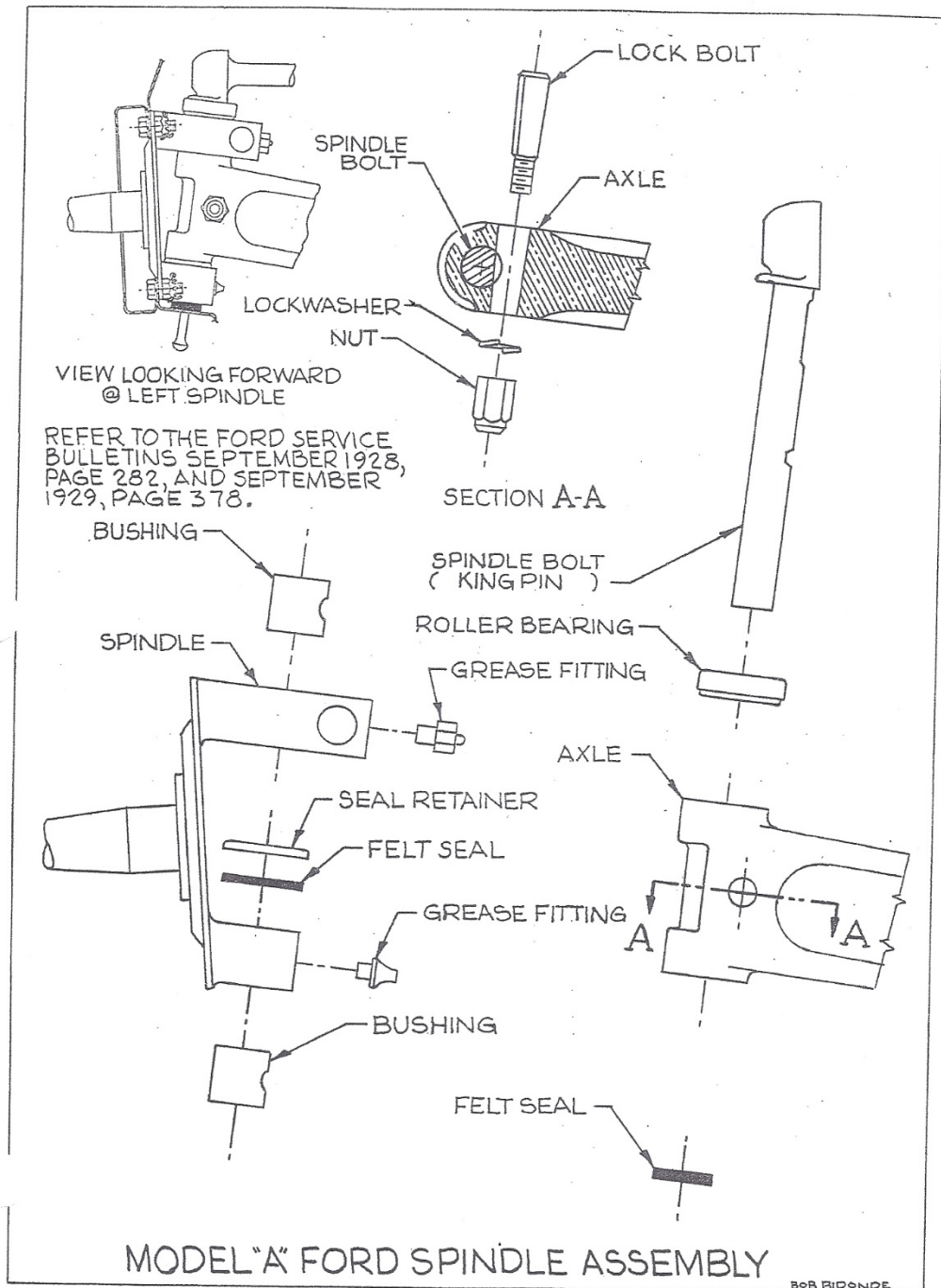

VIEW LOOKING FORWARD @ LEFT SPINDLE

REFER TO THE FORD SERVICE BULLETINS SEPTEMBER 1928, PAGE 282, AND SEPTEMBER 1929, PAGE 378.

SECTION A-A

MODEL "A" FORD SPINDLE ASSEMBLY

BOB BIDONDE

From the collections of Henry Ford Museum & Greenfield Village Research Center

Ford Parts + Service U114-1120-M31

Thank You and Good Night

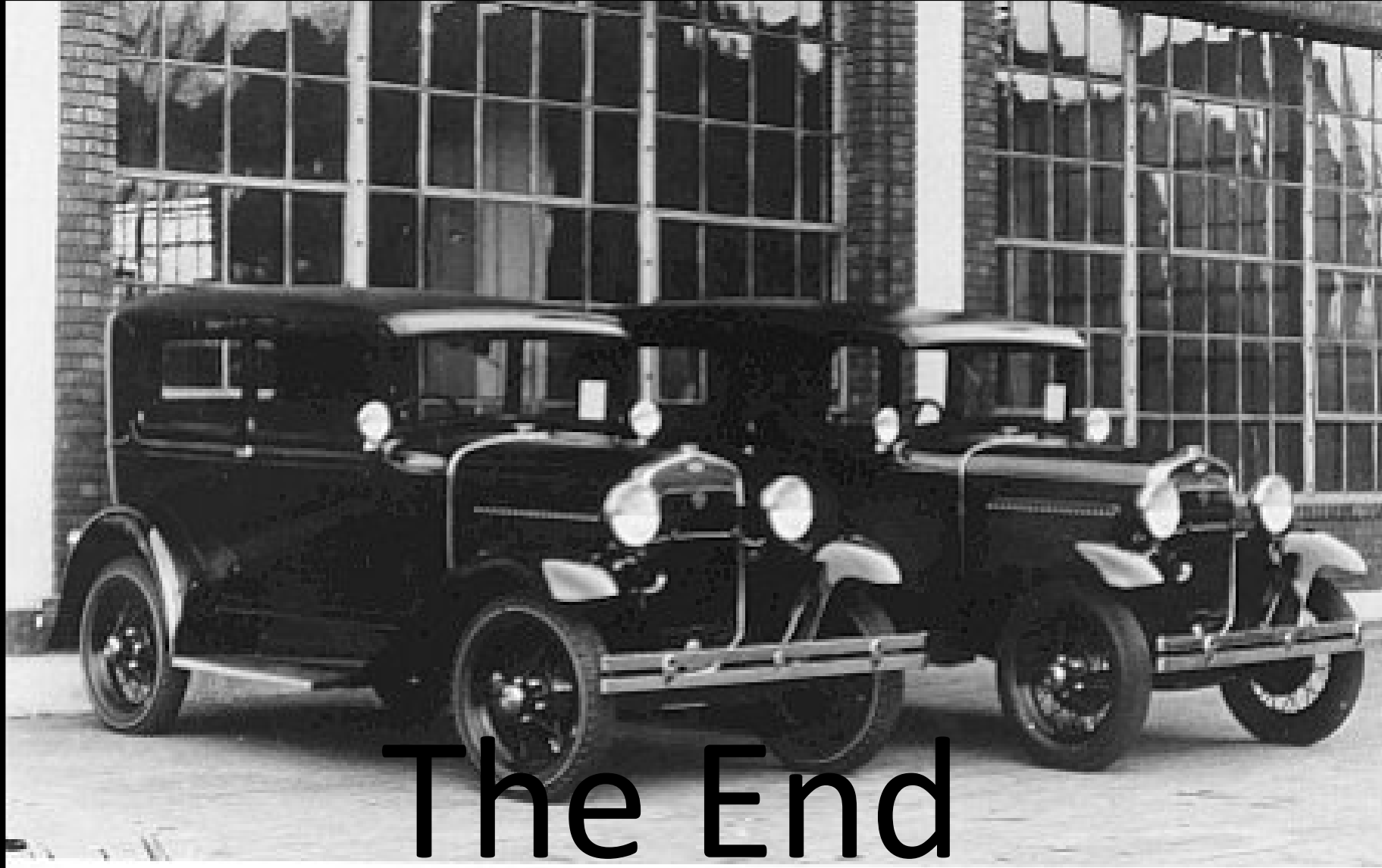

The End